



ResMed

AirCurve™ 11

VAUTO

S

ASV



User guide

English | Français | Español | Português

Contents

Welcome	1
Indications for use	1
Contraindications	1
Adverse effects	1
Software functionality and device data	2
At a glance	3
About your device	5
Setting up your device	6
Pre-use check	8
Navigating the touch screen	9
Additional features	10
Connecting your AirCurve 11 device and smart device	11
Starting/Stopping therapy	12
My Sleep View	12
About the heated tubing	13
Therapy data	14
Cleaning and caring for the device	16
Disassembling	17
Cleaning	17
Checking	18
Replacing the air filter	18
Reassembling	18
Traveling	19
Traveling by plane	19
Troubleshooting	20
General warnings	22
Technical specifications	23
Symbols	28
Servicing	29
Limited warranty	29
Further information	30

Quick setup view

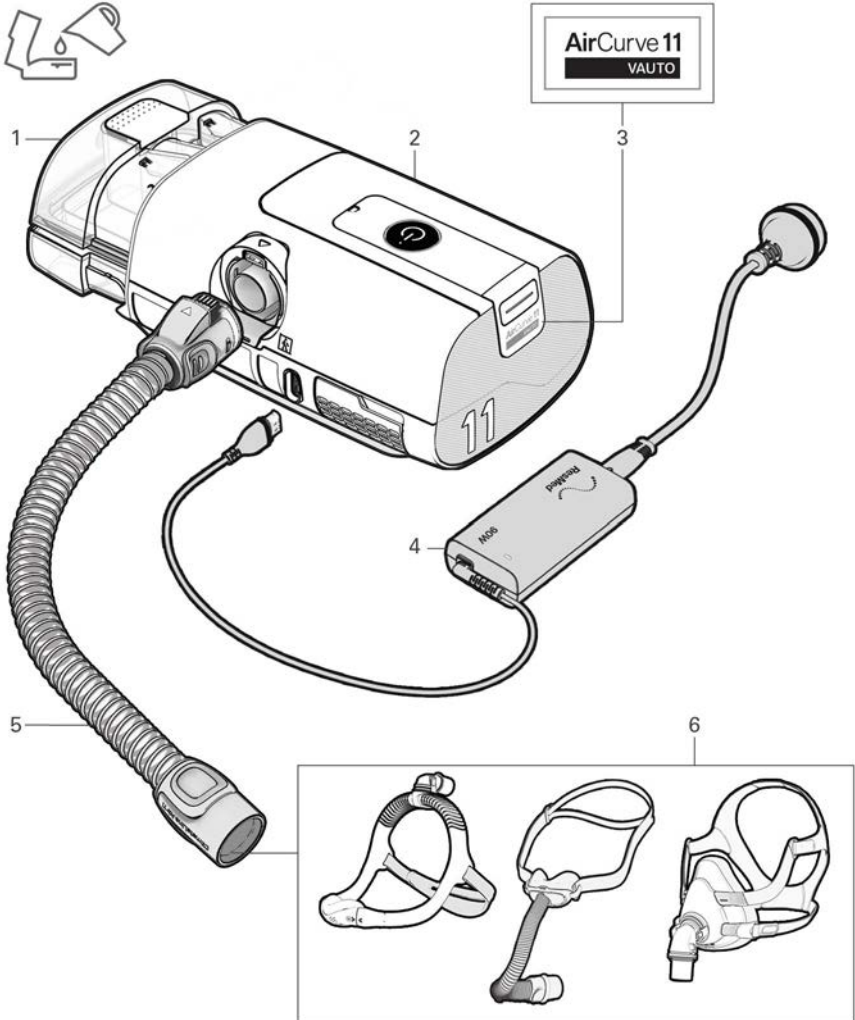

Components

1. HumidAir™ tub
2. AirCurve™ 11 device
3. Device identification plaque (eg, AirCurve 11 VAuto, AirCurve 11 S, AirCurve 11 ASV)
4. Power Supply unit
5. ClimateLineAir™ 11 tubing
6. Mask

Welcome

The AirCurve 11™ VAuto and AirCurve 11 S are bilevel positive airway pressure devices. The AirCurve 11 ASV is a positive airway pressure device that belongs to the adaptive servo-ventilator category.

WARNING

- Read this entire guide before using the device.
- This device is not suitable for ventilator-dependent patients.
- Before putting patients on ASV, each patient should be assessed for heart failure. In case of signs and symptoms of heart failure an objective assessment of Left Ventricular Ejection Fraction (LVEF) should be performed.

CAUTION

In the US, Federal law restricts this device to sale by or on the order of a physician.

Indications for use

AirCurve 11 VAuto

The AirCurve 11 VAuto system is indicated for the treatment of Obstructive Sleep Apnea (OSA) in patients weighing more than 66 lb (30 kg). The AirCurve 11 VAuto system is intended for use in the hospital and home.

AirCurve 11 S

The AirCurve 11 S system is indicated for the treatment of Obstructive Sleep Apnea (OSA) in patients weighing more than 66 lb (30 kg). The AirCurve 11 S system is intended for use in the hospital and home.

AirCurve 11 ASV

The AirCurve 11 ASV system is indicated for the treatment of Obstructive Sleep Apnea (OSA) in patients weighing more than 66 lb (30 kg). ASV and ASVAuto modes are also indicated for the treatment of central and/or mixed apneas, or periodic breathing. The AirCurve 11 ASV system is intended for use in the hospital and home.

Hypoallergenic filter

The hypoallergenic filter provides air filtration during PAP (Positive Airway Pressure) therapy.

HumidAir 11

The HumidAir 11 enables the provision of humidification. It is intended for home and hospital use.

Contraindications

Positive airway pressure therapy may be contraindicated in some patients with the following pre-existing conditions:

- severe bullous lung disease
- pneumothorax or pneumomediastinum
- pathologically low blood pressure, particularly if associated with intravascular volume depletion
- dehydration
- cerebrospinal fluid leak, recent cranial surgery, or trauma.

ASV therapy is contraindicated in patients with chronic, symptomatic heart failure (NYHA 2-4) with reduced left ventricular ejection fraction (LVEF \leq 45%) and moderate to severe predominant central sleep apnea.

Adverse effects

You should report unusual chest pain, severe headache, or increased breathlessness to your prescribing physician. An acute upper respiratory tract infection may require temporary discontinuation of treatment.

The following side effects may arise during the course of therapy with the device:

- drying of the nose, mouth, or throat
- nosebleed
- bloating

- ear or sinus discomfort
- eye irritation
- skin rashes.

Software functionality and device data

This ResMed device is a smart device and includes software functionalities which allow it to be connected to the cloud so that users and their care providers can access data about therapy remotely, receive regular upgrades to the device and much more. Check out <https://myair.resmed.com/> to learn about ResMed's patient coaching application, myAir™.

Software License

License Grant. Subject to the terms and conditions below, ResMed grants you, the owner and/or user of this device, a perpetual, non-exclusive, non-sublicensable, personal, limited license to use the ResMed Software solely in connection with the use of this device. All other rights are reserved by ResMed. You will be deemed to have transferred and assigned this license to any person that acquires the owner's or the user's rights in this device.

License Restrictions. Software included on or with this device is owned by or licensed to ResMed (the "ResMed Software"). Neither the ResMed Software nor any intellectual property rights in the ResMed Software are sold or assigned by ResMed. No person or entity is licensed or authorized to (a) reproduce, distribute, create derivative works, modify, display, perform, decompile or attempt to discover the source code for the ResMed Software, (b) remove or attempt to remove the ResMed Software from the ResMed product, or (c) reverse engineer or disassemble the ResMed product or the ResMed Software. For avoidance of doubt, the foregoing restrictions are not intended to limit any licensee's rights to software code incorporated into or distributed with the ResMed Software and licensed under the terms of any open source, free or community software license (collectively, "Open Source Software").

Over-the-Air Download of Software Updates. If the device is connected to the cloud, then the ResMed Software on the device will automatically and periodically download updates and upgrades to the ResMed Software on the device. Such downloads may be done by various means including, but not limited to, using Bluetooth® wireless technology, WiFi and/or cellular networks and combinations of various wireless technologies and services. Such updates to the ResMed Software might include, without limitation, bug fixes, error corrections, security patches, and new versions and releases of the ResMed Software that may include changes to existing features or functions and/or the addition of new features and functions.

Use of Device Data

When you use this device it gathers and records data about your use and, if your device connectivity is enabled, the device sends certain data to ResMed via the cloud to enable ResMed to deliver various benefits to you and your care provider(s). Additionally, some of that data may be used by ResMed (1) to comply with its legal obligations; these legal obligations include collection and analysis of device data for medical device post market surveillance and vigilance, and compliance with these legal obligations includes assessing if ResMed is required to implement actions to improve device safety, usability and performance, and (2) to perform health-related research, study and/or evaluation for specific scientific and medico-economic purposes. ResMed will only use your device data in compliance with applicable laws and regulations in your country or region (for example the GDPR (Regulation (EU) 2016/679 of the European Parliament and of the Council of 27 April 2016 on the protection of natural persons with regard to the processing of personal data and on the free movement of such data), the MDR (Regulation (EU) 2017/745 of the European Parliament and of the Council of 5 April 2017 on Medical Devices)) in the European Union, and, as applicable, HIPAA (the Health Insurance Portability and Accountability Act of 1996) in the USA). Depending on the data protection or privacy laws of your country or region your device data may constitute your personal data. If so, ResMed has the obligation to inform you about your rights and freedoms for our use of your personal data. You can find more details related to our use of your data, your rights to access, rectify, erase, restrict or object at <https://www.resmed.com/myprivacy/>.

At a glance

WARNING

Use only recommended ResMed masks and accessories or other vented masks as recommended by the prescribing doctor with this device. Using these components allows normal breathing and prevents potential asphyxiation.

The AirCurve 11 system includes the following:

- Device
- HumidAir 11 Standard tub
- HumidAir 11 Cleanable tub
- ClimateLineAir 11 heated tubing or SlimLine™ tubing
- Air 11™ Power supply unit: 90W AC adaptor
- Travel bag
- SD card (not available in all devices).

Contact your care provider or refer to the ResMed website ([ResMed.com/productsupport](https://www.resmed.com/productsupport)) for a range of spares and compatible accessories available for use with the device including:

- Air tubing (ClimateLineAir 11, SlimLine, Standard 2m and Standard 3m)
- HumidAir 11 Standard tub (Single patient re-use - cannot be reprocessed)
- HumidAir 11 Cleanable tub (Multi patient re-use - can be reprocessed)
- Side cover which allows use without the humidifier tub
- Air11 Filter - standard
- Air11 Filter - hypoallergenic
- Air11 DC/DC converter
- SD card
- SD card cover

Notes:

- The AirCurve 11 device is compatible with ResMed masks. For a complete list, see the Mask/Device compatibility list on [ResMed.com/downloads/devices](https://www.resmed.com/downloads/devices).
- The HumidAir 11 Standard tub and the HumidAir 11 Cleanable tub are the only water tubs used with the AirCurve 11 device.
- The ClimateLineAir 11 is the only heated tubing that is compatible with the AirCurve 11 device.
- This device is suitable for use with the Air11 90W AC power supply unit and 90W DC-DC converter. The Air11 65W AC Adaptor can be used with the AirCurve 11 device but there may be some degradation of the humidifier performance when mouth or mask leak is present.
- To reduce the likelihood of disconnection and to prevent adverse ventilator performance use only accessories compatible with the ventilator. Compatibility is determined by reviewing the instructions for use of either the ventilator or the accessories.

Humidifier tubs

HumidAir 11 Standard tub

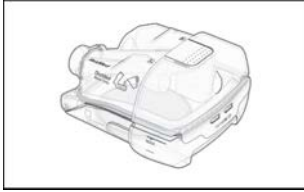

- single-patient use only
- cannot be reprocessed
- has a white thumb grip
- fill with distilled water only

HumidAir 11 Cleanable tub

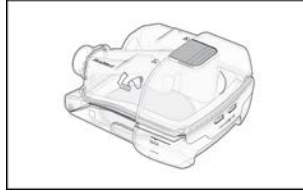

- multi-patient use
- can be reprocessed
- has a gray thumb grip
- fill with drinking quality water (potable)

About your device

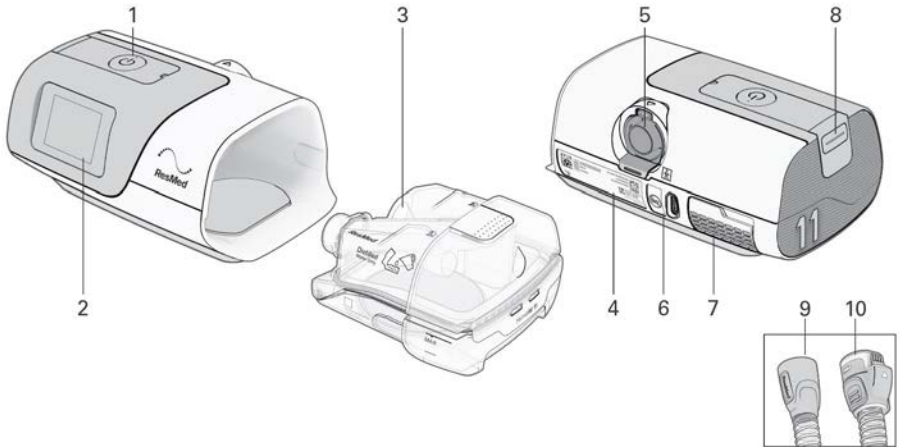

Description	Purpose
1 Start Therapy/ Standby button	Press to start/stop therapy. The LED indicator is green during standby mode, and white during therapy, Test Drive , and Mask Fit functions.
2 Display touch screen	Navigates between functions and displays information on the operating status of the device.
3 HumidAir 11 tub	Water tub that provides heated humidification.
4 Device label	Contains information relevant to the device.
5 Outlet connector	Connects the air tubing
6 Power inlet	Connects the power cord
7 Air inlet filter cover	Contains the air filter
8 SD card cover	Removable cover that protects the SD card slot. The LED indicator is blue when data is written to the SD card.
9 SlimLine tubing	Non-heated air tubing
10 ClimateLineAir 11 tubing	Heated air tubing

Notes:

- If the Start therapy/ Standby button has a flashing white light, a system error has occurred. Refer to the Troubleshooting section for more information.
- Use this device only as directed by your physician or healthcare provider
- Prior to use the responsible organization needs to ensure the compatibility of the device and all of the parts and accessories with which the device is intended to be used.

Setting up your device

WARNING

Do not use any additives in the humidifier tub (eg, scented oils or perfumes). These may reduce humidification output and/or cause deterioration of the tub materials.

CAUTION

Use only ResMed parts (eg, air inlet filter, power supplies), masks and accessories with the machine. Non ResMed parts may reduce the effectiveness of the treatment, may result in excess carbon dioxide rebreathing and/or damage the machine. For compatibility information, refer to ResMed.com for more information.

When using the humidifier tub:

- Always place the device on a level surface, lower than your head, to prevent the mask and air tubing from filling with water.
- Do not overfill the humidifier tub as water may enter the device and air tubing.
- Do not fill the humidifier tub with hot water as this could lead to excessive air temperature at the mask. Ensure the water is cooled to room temperature before filling the humidifier tub.
- Do not place the device on its side while the humidifier is attached as water might get into the device and reduce motor life.

When setting up the AirCurve 11 system:

- Do not place the power supply where it can be bumped, stepped on, or where someone is likely to trip over the power cord.
- Do not block the air tubing and/or air inlet of the device while in operation as this could lead to overheating of the device.
- Keep the area around the device dry, clean and clear of anything (eg, clothes or bedding) that could block the air inlet or cover the power supply unit.
- Ensure the system is correctly set up. Incorrect system setup may result in incorrect mask pressure reading.

When using a mask:

- Use only vented masks recommended by ResMed or by the prescribing doctor with this device.
- Fitting the mask without the device blowing air can result in rebreathing of exhaled air.
- Make sure that the mask vent holes are kept clear and unblocked to maintain the flow of fresh air into the mask.

To set up the device:

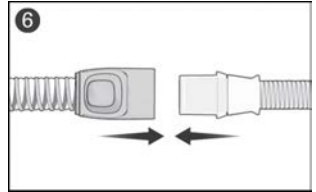
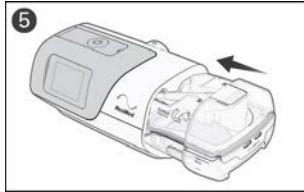
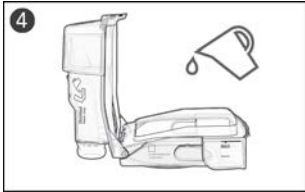
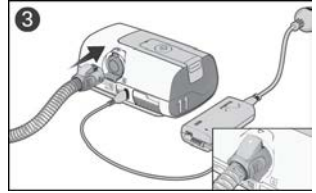
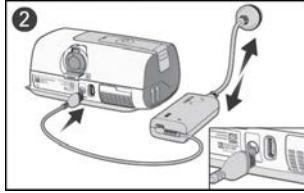
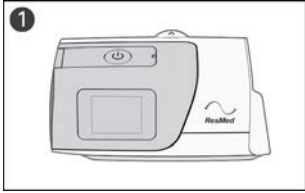

1. Place the device on a stable level surface.
2. Connect the power cord into the power inlet at the rear of the device. Connect one end of the power cord into the AC adaptor and the other end into the power outlet. Ensure the device is set up and connected to power to enable settings to be applied wirelessly to the device if required.
3. Connect the air tubing firmly to the outlet connector at the rear of the device.
4. Open the humidifier tub and fill it with water.
Note: The humidifier tub must be removed from the device before adding water.
 - If using the HumidAir 11 Standard water tub, use distilled water only
 - If using the HumidAir 11 Cleanable water tub, use drinking quality water (potable).Fill the water tub up to the maximum water level mark. The humidifier tub has a maximum capacity of 380 mL.
5. Close the humidifier tub and insert it into the side of the device.
6. Connect the free end of the air tubing firmly onto the assembled mask.
See the mask user guide for detailed information.

Recommended masks for use with this device are listed on ResMed.com.

Notes:

- Do not insert any USB cable into the AirCurve 11 device or attempt to plug the AC adaptor into a USB device. This may cause damage to the AirCurve 11 device or USB device.
- The electrical connector end of the heated air tubing is only compatible with the air outlet at the device end and should not be fitted to the mask.
- Do not use electrically conductive or anti-static air tubing.

Pre-use check

Prior to use, the following steps shall be performed to determine if the device is operating correctly and ready for use. If any problems occur, see the Troubleshooting section of this guide. Also refer to other provided user instructions for troubleshooting information.

With the device powered off:

1. Check the condition of the device and accessories.
Inspect the device and all the provided accessories (eg. HumidAir 11 humidifier tub, air tubing, mask). If there are any visible defects the component should not be used.
2. Check the air tubing set up.
Check the integrity of the air tubing. Connect the air tubing firmly to the outlet connector and other accessories if in use.

With the device powered on:

When using the humidifier tub:

1. Fill the humidifier tub and check the water level does not exceed the maximum water level mark. Insert the humidifier tub into the device.
2. From the Home screen tap **MORE**.
3. Tap **Run Warmup**. The screen should display the  symbol if the humidifier is in use and the humidity level has been set.
4. Check air is flowing through the air tubing. Press the Start Therapy/ Standby button or if SmartStart has been enabled, breathe into the mask and therapy will start automatically.









When using the side cover:

1. Check the side cover is inserted correctly. It should click in place.
2. Check the display screen for any error messages.
3. Check air is flowing through the air tubing. Press the Start Therapy/ Standby button or if SmartStart has been enabled, breathe into the mask and therapy will start automatically.

Navigating the touch screen

The AirCurve 11 device operates via a display touch screen, which allows you to access, view and change therapy and device settings. You can also track your sleep health progress.

The status bar at the top of the screen may display icons at different times and may include:

Icon	Description	Purpose
	Home Screen	Return to the Home screen at any time.
	Humidifier fault	Detects fault in the humidifier. Therapy will run without heating.
	Humidifier warming	Water in the humidifier tub is pre-heating.
	Humidifier cooling	Water in the humidifier tub is cooling.
	Device cooling	Side cover is connected and device is cooling.
	Bluetooth connected	Device is successfully connected via Bluetooth wireless technology.
	Cellular signal strength	Indicates the strength of cellular connectivity.
	No cellular connection	Cellular coverage is not available.
	Airplane mode	Device is in airplane mode.

Initial Setup

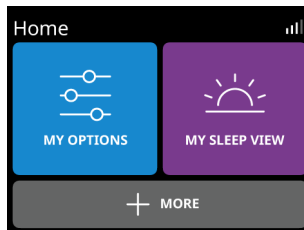
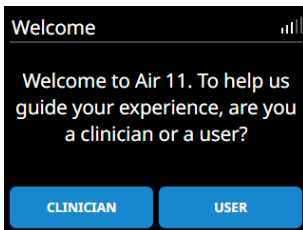

From the **Welcome** screen, tap **USER** and follow the prompts.

1. From the **Home** screen, you can access the following menus:

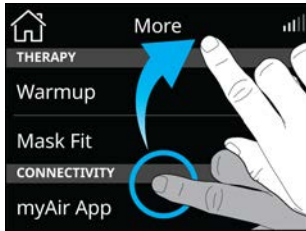

- **MY OPTIONS:** View and adjust therapy settings (eg, Adjust Ramp time)
- **MY SLEEP VIEW:** Track sleep health (check the number of hours used last night or mask status)
- **MORE:** Access additional features such as Run Mask Fit or switch to Airplane mode.

Using the touch screen:



There are two actions to navigate through the touch screen:

Swipe: Swipe up or down the screen to view menu options.

Tap: Select a parameter setting to update. For other parameters (eg Pressure Relief, Airplane mode), tap the parameter to turn it on  or tap to turn it off .

Prescription settings

If you have received the device direct to your home, prescription settings may not have been applied to your device. Ensure a wireless connection has been established to enable your care provider to install the prescribed settings.

Personalizing your settings

The device can be set up for your needs by your care provider, but you may want to make adjustments to make your therapy more comfortable.

1. Tap **MY OPTIONS** from the **Home** screen.
2. Tap the parameter you wish to change.
3. Tap the preferred setting.



Tap **OK** to confirm the change or **CANCEL** to go back to the previous screen.

Additional features

There are some other features on your device which you can personalize.

Note: Not all functions are available in all regions. Functions vary based on therapy mode.

Menu	Function	Description
MY OPTIONS	Ramp Time	Period during which the pressure increases from a low start pressure to the prescribed treatment pressure. Ramp Time can be set to Off or 5 to 45 minutes (in 5-minute increments).
	Pressure Relief*	When EPR (Expiratory Pressure Relief) is enabled, you may find it easier to breathe out. This setting can help you get used to therapy.
	Mask	Allows you to select the type of mask used with the device.
	Tube	Allows you to select the type of tubing used with the device.
	SmartStart™*	When SmartStart is enabled, therapy starts automatically when you breathe into your mask.
SmartStop*	When SmartStop is enabled, therapy stops automatically after a few seconds when you remove your mask.	

Menu	Function	Description
MORE	Run Warmup	This function will heat the water in the humidifier tub.
	Mask Fit	This function helps you assess and identify possible air leaks around your mask.
		 Indicates good mask seal. Leak is less than 24L/min.  Adjust the mask. Leak is more than 24L/min.
Device Diagnostic	When enabled, Device Diagnostics will analyze the functionality of the device. See ResMed.com for further details. Device Diagnostic can be set to run Daily, Weekly, every 2 weeks, or it can be switched off.	

*Features enabled by an appropriate care professional.

Connecting your AirCurve 11 device and smart device

myAir is a smartphone app that guides you through the setup process. This includes device setup videos, mask fitting videos, trying therapy using the Test Drive feature, and tracking your sleep health progress. The app is not required to operate the AirCurve 11 device.

Before pairing the AirCurve 11 device to a smartphone, ensure the app's latest version is installed on the smartphone. If not, download the app from the App Store® or on Google Play®. Pair the AirCurve 11 device to your phone. To set up the app, go to the **MORE** menu.

1. Ensure your AirCurve 11 device is set up correctly and plugged into a power source.
2. Launch the myAir app. Tap **Continue**.
3. Follow the prompts on the myAir app to complete the Bluetooth connection.
AirCurve 11 is now connected to the app. The Bluetooth connection symbol appears on the status bar to confirm the connection between the AirCurve 11 device and the smartphone.
4. Tap **Save**.

Starting/Stopping therapy

WARNING

The machine is not intended to be operated by persons (including children) with reduced physical, sensory or mental capabilities without adequate supervision by a person responsible for the patient's safety.

To start therapy:

1. Fit your mask
2. Press the Start Therapy/ Standby button or breathe normally if SmartStart is enabled

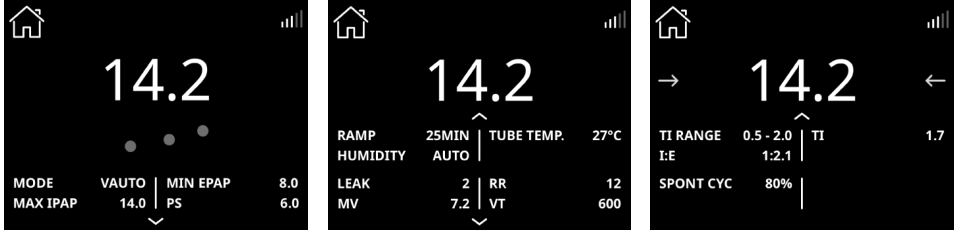

Therapy will begin and the treatment screen is displayed. A dynamic pulse wave will appear during therapy.

To review your sleep progress, click on  to view more details

Notes:

- The screen will fade and then go black automatically after a short period of time. Tap the screen to turn it back on.
- If power is interrupted during therapy, the device will automatically restart therapy when power is restored.
- The device has a light sensor that adjusts the screen brightness based on the light in the room.

To stop therapy:

1. Remove your mask.
2. Press the Start Therapy/ Standby button or wait until the device stops if SmartStop is enabled.

My Sleep View

Last night's sleep data can be found under **MY SLEEP VIEW**.



USAGE: displays HOURS USED LAST NIGHT

EVENTS: displays the number of apnea and hypopnea events per hour of sleep.

MASK: displays information on the mask seal. A yellow mark on this icon indicates there is information to view on the mask seal. Tap **MASK** to see more.

More detailed data can be found in myAir (if available). If enabled by your care professional, additional data may be found by tapping on .

About the heated tubing

The ClimateLineAir 11 is a heated breathing tube that delivers air to a compatible mask. When used with the device humidifier tub, ClimateLineAir 11 heated air tubing allows you to use the Climate Control feature.

Note: Not all types of air tubing are available in all regions.

Climate Control

Climate Control is designed to make therapy more comfortable by enabling constant temperature and maintaining humidity.

This feature:

- delivers comfortable humidity level and temperature during therapy
- maintains the set temperature and relative humidity during sleep to prevent dryness in the nose and mouth
- can be set to either **Auto** or **Manual**
- is only available when both the ClimateLineAir 11 and HumidAir 11 tub are attached.

Climate Control - Auto setting

Auto is the recommended and default setting. It is designed to make therapy as easy as possible so there is no need to change the temperature or humidity settings.

- Sets the tube temperature to Auto (80°F/27°C). If the air in the mask is too warm or too cold, you can adjust the tube temperature to anywhere from 60 to 86°F (16 to 30°C) or turn it off completely
- Adjusts the humidifier output to maintain a constant, comfortable humidity level of 85% relative humidity
- Protects against rainout (water droplets in the heated air tubing and mask).

Climate Control - Manual setting

Manual is designed to offer more flexibility and control over settings and offers the following:

- Temperature and humidity can be adjusted to find the most comfortable setting
- Temperature and humidity level can be set independently
- Rainout protection is not guaranteed. If rainout does occur, first try increasing the tube temperature
- If the air temperature becomes too warm and rainout continues, try decreasing the humidity.

Note: If Climate Control is set to **Manual**, the **Auto** Tube Temperature setting is not available.

Humidity Level

The humidifier moistens the air and is designed to make therapy more comfortable.

- If you are getting a dry nose or mouth, turn up the humidity
- If you are getting any moisture in your mask, turn down the humidity.
- You can set the **Humidity Level** to Off or between 1 and 8, where 1 is the lowest humidity setting, and 8 is the highest humidity setting.

To update the setting for **Tube Temperature**, **Climate Control**, or **Humidity Level**, tap **MY OPTIONS** from the **Home** screen, go down the list of options, and select the setting.

Note: Tube Temp **Auto** setting is only relevant when using the **Climate Control Auto** setting. If **Climate Control** is set to **Manual**, **Auto** set temperature is not a valid selection.

Tube Temperature

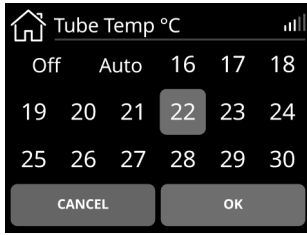

1. Tap **Tube Temp**.
2. Tap the preferred setting.
3. Tap **OK** to save the change.

Climate Control

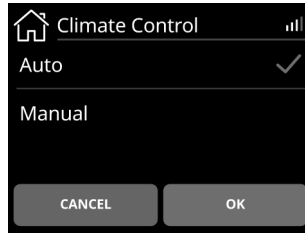

1. Tap **Climate Control**.
2. Tap **Manual**.
3. Tap **OK** to save the change.

Humidity Level

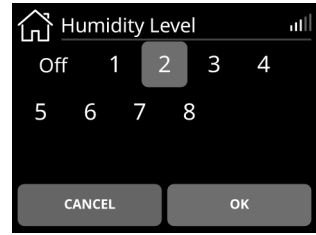

1. Tap **Humidity Level**.
2. Tap the preferred setting.
3. Tap **OK** to save the change.

Note: The temperature and humidity settings are not measured values.

Therapy data

The AirCurve 11 device records your therapy data for viewing and adjusting by your care provider if required. The data is transferred to your care provider in the following methods:

Wireless

The device is equipped with cellular communication that allows your sleep therapy data to be wirelessly transmitted to your care provider. It also allows for prescribed settings to be applied or updated.

Transfer of data will occur after therapy has stopped. Leave your device connected to the power outlet at all times and make sure it is not in Airplane Mode. Data will only be transferred if a wireless connection is available.

Within the wireless network, the availability and quality of the network may be affected by terrain, buildings, and the weather. Wireless communication depends on network availability. Coverage is not available everywhere and varies by service.

Notes:

- Cellular feature may not work/ therapy data might not be transmitted if you use it outside of the country or region of purchase.
- Devices with cellular communication might not be available in all regions.

SD card

Your sleep therapy data may be transferred to your care provider via SD Card (if provided). Your care provider may ask you to send the SD card by mail or to bring it in. Only remove the SD card when instructed by your care provider.

To use the SD card to record your sleep data, remove the SD card cover.

Do not remove the SD card from the device when the SD light is flashing, because data is being written to the card.

Note: The SD card should not be used for any other purpose as it may corrupt therapy data stored on the card.

To remove the SD card cover and insert SD card:

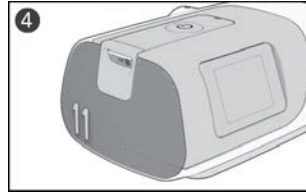
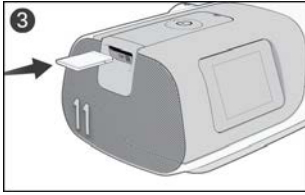
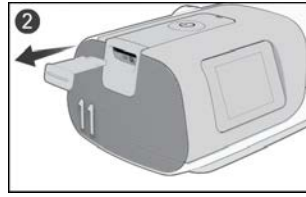
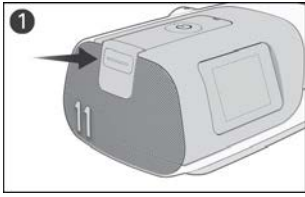

1. Push the SD card cover.
2. Remove the SD card cover and keep the SD card cover in a safe place.
3. Insert the SD card.
4. Push in the SD card until it clicks in place.

To remove the SD card:

1. Push in the SD card to release it.
 2. Place the SD card in the protective folder and follow your care provider's instructions.
- For more information on the SD card, refer to the SD card protective folder provided with your device.

Cleaning and caring for the device

WARNING

- Beware of electrocution:
 - Do not immerse the device, AC Adaptor or power cord in water.
 - Do not connect to power while the device is wet. Make sure that all parts are dry before plugging it in.
 - If liquids are spilled into or onto the device, unplug the device and let the parts dry.
- Always unplug the device before cleaning and ensure that all parts are dry before plugging it back in.
- Do not perform any maintenance tasks (eg, cleaning, changing the air filter) while the device is in operation.
- Clean the device and its components according to the schedules shown in this guide, to maintain the quality of the device and to prevent the growth of germs that can adversely affect your health.
- Regularly inspect power cords, cables, and power supply for damage or signs of wear. Discontinue use and replace if damaged.
- Do not open or modify the device. There are no user serviceable parts inside. Repairs and servicing should only be performed by an authorized ResMed service agent.

CAUTION

- Do not use bleach, chlorine, or aromatic-based solutions, moisturizing or antibacterial soaps or scented oils to clean the device, the humidifier tub or air tubing. These solutions may cause damage or affect the humidifier performance and reduce the life of the products. Exposure to smoke, including cigarette, cigar or pipe smoke, as well as ozone or other gases, may damage the device. Damage caused by any of the foregoing, will not be covered by ResMed's limited warranty.
- Leave the humidifier tub to cool for at least ten minutes after turning off the humidifier or until the cool down mode is complete before handling the humidifier tub.
- Only clean, maintain and/or reprocess the device and components according to the instructions shown in this guide.

The following sections will help you with:

- Disassembling
- Cleaning
- Checking
- Reassembling.

Disassembling

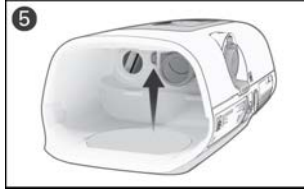
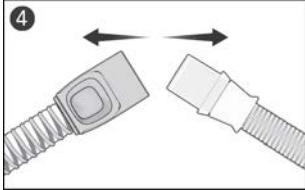
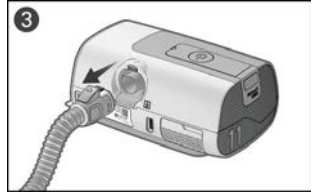
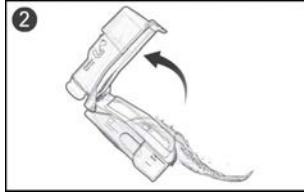
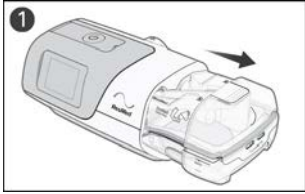

1. Hold the humidifier tub at the top and bottom, press it gently and pull it away from the device.
Note: take care when handling the humidifier tub as the humidifier tub may be hot. Allow 10 minutes for the heater plate and any excess water to cool.
2. Open the humidifier tub and discard any remaining water.
3. Pinch the cuff of the air tubing, and gently pull it away from the device.
4. Hold both the cuff of the air tubing and the swivel of the mask, then gently pull apart.
5. Locate the outlet connector on the inside of the device and release it by pressing the clip firmly.
6. Remove the outlet connector by pulling it out through the outlet connector socket at the rear of the device.

Cleaning

The following instructions are for home cleaning. Instructions for reprocessing devices intended for multi-patient re-use can be found in the clinical guide.

You should clean the device, humidifier tub, air tubing, and outlet connector as described. For cleaning your mask, refer to the mask user guide for detailed instructions.

Daily:

1. Empty the humidifier tub and wipe it thoroughly with a clean disposable cloth. Allow it to dry out of direct sunlight.
2. Refill the humidifier tub.
 - If using the HumidAir 11 Standard water tub, use distilled water only
 - If using the HumidAir 11 Cleanable water tub, use drinking quality water (potable).

Weekly:

1. Wash the components as described:
 - Air tubing - in warm water using a mild dishwashing liquid.
 - Humidifier tub - in warm water using a mild dishwashing liquid OR in a solution with a ratio of 1 part vinegar and 9 parts water at room temperature.
 - Outlet connector - in warm water using a mild dishwashing liquid OR in a solution with a ratio of 1 part vinegar and 9 parts water at room temperature.
 - Components should not be washed in temperatures higher than 131°F (55°C).
2. Rinse each component thoroughly in water.
3. Allow to dry out of direct sunlight or heat
4. Wipe the exterior of the device with a dry cloth.

Notes:

- The humidifier tub and outlet connector may be washed in a dishwasher.
- Do not wash the air tubing in a dishwasher or washing machine.
- The air filter is not washable or reusable.

Checking

WARNING

- Discontinue use and contact your care provider or ResMed Service Center if any of the following occur:
 - device does not perform as usual
 - device is making unusual sounds
 - device is damaged
- If using a bacterial/viral filter, regularly check it for signs of moisture or other contaminants, particularly during nebulization or humidification. Failure to do so could result in increased breathing resistance or affect the delivery of the therapeutic pressure.

CAUTION

If any visible deterioration of a system component is apparent (cracking, discoloration, tears etc.), the component should be discarded and replaced.

Regularly check the humidifier tub, air tubing, and air filter for any damage.

1. Check the humidifier tub:
 - Replace it if it is leaking or has become cracked, cloudy, or pitted.
 - Replace it if the seal is cracked or torn.
 - Remove any white powder deposits using a solution of 1 part household vinegar to 9 parts water. Rinse with clean water.
2. Check the air tubing and replace it if there are any holes, tears, or cracks.
3. Check the air filter and replace it every six months. Replace it more often if there are any holes or blockages by dirt or dust.

Replacing the air filter

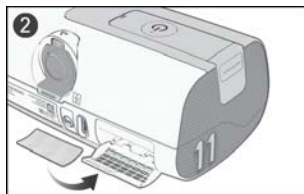
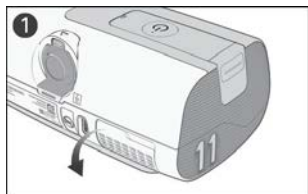

1. Open the air filter cover and remove the old air filter.
2. Place a new air filter onto the air filter cover and then close the cover. Make sure the air filter and air filter cover are fitted at all times to prevent water and dust from entering the device.

Note: The air filter is not washable or reusable.

Reassembling

When the components are dry, you can reassemble the parts.

To reassemble the AirCurve 11 system:

1. Hold the outlet connector with the seal pointing to the left and the clip pointing forward.
2. Make sure the outlet connector is correctly aligned and insert the outlet connector into the socket.
3. Check the outlet connector is inserted correctly.

4. Connect the air tubing firmly to the air outlet located on the rear of the device.
5. Open the humidifier tub and fill it with water up to the maximum water level mark.
 - If using the HumidAir 11 Standard water tub, use distilled water only
 - If using the HumidAir 11 Cleanable water tub, use drinking quality water (potable)
6. Close the humidifier tub and insert it into the side of the device.
7. Connect the free end of the air tubing firmly onto the assembled mask.

For further assistance, refer to Setting up your device.

Traveling

You can take your device with you wherever you go. Just keep the following in mind:

- Use the travel bag provided to prevent damage to the device.
- Empty the humidifier tub and pack it separately in the travel bag.
- Make sure you have the appropriate power cord for the region you are traveling to. For information on purchasing, contact your care provider.

Traveling by plane

WARNING

- Do not use the device with water in the humidifier tub while in transit (eg, on a plane or vehicle) due to the risk of:
 - water spilling into the device
 - the inhalation of water during turbulence.
- Make sure that the humidifier tub is empty before transporting the device.

Your AirCurve 11 device may be taken on board as carry-on luggage. Medical devices do not count toward your carry-on luggage limit.

You can use your AirCurve 11 device on a plane as it meets the Federal Aviation Administration (FAA) requirements. Air travel compliance letters can be downloaded and printed from www.resmed.com.

When using the device on a plane:

- Make sure the humidifier tub is empty and inserted into your device. The device will not work without the humidifier tub or side cover inserted.
- Make sure the device is switched to airplane mode when required by airline staff.

To turn on Airplane mode:

1. From the Home screen, tap **MORE**.
2. Swipe through the menu to locate **Airplane Mode**.
3. Tap **Airplane Mode** to switch it on.

Troubleshooting

If you have any problems, have a look at the following troubleshooting topics. If you are not able to fix the problem, contact your care provider or ResMed. Do not try to open the device.

General Issues

Problem/possible cause	Solution
Air is leaking from around my mask Mask may be fitted incorrectly.	Make sure your mask is fitted correctly. See your mask user guide for fitting instructions, run the mask fit function or refer to the Mask Fit video in the myAir app.
I am getting a dry or blocked nose Humidity level may be set too low.	Increase the Humidity Level .
I am getting droplets of water on my nose, in the mask and air tubing Humidity level may be set too high. Tube temperature may be too low.	Decrease the Humidity Level . Increase the Tube Temperature .
My mouth is very dry and uncomfortable Air may be escaping through your mouth.	You may need a chin strap to keep your mouth closed or a full face mask.
There is too much air flowing through my mask Ramp may be turned off	Try the Ramp Time option. This is found under MY OPTIONS menu
There is not enough air flowing into my mask Ramp may be in progress Ramp start pressure may be too low	Wait for the air pressure to build up to turn Ramp Time off Increase the Ramp start pressure
My screen is black Power may not be connected.	Connect the AC adaptor and make sure the plug is fully inserted.
I have stopped therapy but the device is still blowing air Device is cooling down	Device blows a small amount of air in order to avoid condensation in the air tubing. It will stop automatically after 30 minutes.
My humidifier tub/side cover is leaking Humidifier tub may not be assembled correctly. Side cover may not be inserted correctly. Humidifier tub/side cover may be damaged or cracked.	Check for damage and reassemble the humidifier tub correctly. Check the side cover to ensure it has been inserted correctly. It should click in place. Contact your care provider for a replacement.
I am not getting enough air/oxygen flow is disrupted Tubing or humidifier tub may be blocked	Check air tubing for any blockages. Remove and reassemble the humidifier tub correctly.

Problem/possible cause	Solution
My therapy data has not been sent to my care provider/prescription settings have not been applied to my device	
Wireless coverage may be poor/The no wireless connection icon  is displayed on the top right of the screen.	Make sure that the device is placed where there is coverage (ie, on your bedside table, not in a drawer or on the floor).
Device may be in Airplane Mode.	The wireless signal strength icon  indicates good coverage when all bars are displayed, and poor coverage when fewer bars are displayed. Turn off Airplane Mode .
Data transfer is not enabled for your device.	Talk to your care provider about your settings.
SmartStart is enabled, but the device does not automatically start when I breathe into the mask	
Breath is not deep enough to trigger SmartStart	To start therapy, take a deep breath in and out through the mask, before breathing normally. Press the Start Therapy/ Standby button located on top of the device.
There is excessive leak	Adjust the mask and headgear Air tubing may not be connected properly. Connect firmly at both ends.
SmartStop is enabled, but does not automatically stop when I remove the mask.	
Incompatible mask being used	Only use equipment recommended by ResMed. Contact ResMed or see ResMed.com for more information. If you are using a conduit mask, SmartStop may not work.
Device Messages	
Problem/possible cause	Solution
High leak detected. Check your humidifier or side cover.	
Humidifier tub or side cover may not be inserted properly	Make sure the humidifier tub or side cover is correctly inserted
High leak detected. Connect your tubing.	
Air tubing may not be connected properly.	Make sure the air tubing is firmly connected at both ends.
Mask may be fitted incorrectly.	Make sure the mask is fitted correctly. See the mask user guide for fitting instructions or use the Mask Fit function to check the mask fit and seal.
Tubing blocked. Check your tubing.	
Air tubing may be blocked	Check the air tubing and remove any blockages. Press the Start therapy/standby button to restart the device
Read only card, remove, unlock and re-insert SD card	
SD card switch may be in the lock (read-only) position	Move the switch on the SD card from the lock position  to the unlock position  and then re-insert it.

Problem/possible cause	Solution
System fault, refer to user guide, Error 4	
Device may have been left in a hot environment	Allow to cool before re-use. Disconnect the AC adaptor and then reconnect it to restart the device.
Air filter may be blocked	Check the air filter and replace it if there are any blockages. Disconnect the AC adaptor and then reconnect it to restart the device.
There may be water in the air tubing	Empty the water from the air tubing. Disconnect the AC adaptor and then reconnect it to start the device.
System fault, refer to user guide, Error X	
An error has occurred on the device.	Remove power and restart device. If error persists, contact an appropriate care professional. Do not open the device.

General warnings

WARNING

- Any change or modification to the product is not expressly approved by ResMed and could void the user's authority to operate the device.
- Supplemental oxygen must not be used while smoking or in the presence of an open flame.
- When using the device with an oxygen supply, check the following:
 - Starting therapy – ensure the device is on and blowing air before the oxygen supply is turned on.
 - Stopping therapy – ensure the oxygen supply is turned off first, then the device.
 This will ensure oxygen does not accumulate within the device and create a risk of fire.
- The device has not been tested or certified for use in the vicinity of X-ray, CT or MRI equipment. Do not bring the device within 13 ft (4 m) of X-ray or CT equipment. Never bring the device into an MR (Magnetic Resonance) environment.
- The device should not be used adjacent to or stacked with other equipment. If adjacent or stacked use is necessary, the device should be observed to verify normal operation in the configuration in which it will be used.
- The use of accessories other than those specified for the device is not recommended. These may increase radio frequency energy or be influenced by the interference and result in improper operation.
- Portable RF communications equipment (including peripherals such as antenna cables and external antennas) should be used no closer than 3.9" (10 cm) to any part of the device. Otherwise, degradation of the performance of this equipment could result.
- Do not add any attachments or accessories to the device that are not intended for use in combination with the device, as stated in the instructions for use of the device or accessory, as the device might not function correctly leading to the risk of degradation or loss of ventilatory support.
- Do not use the device outside its approved operating conditions. Using the device above an altitude of 3010m (9800ft) and/or outside the temperature range of 41°F-95°F (5°C-35°C), may reduce the effectiveness of treatment and/or damage the device

Note: For any serious incidents that occur in relation to this device, these should be reported to ResMed and the competent authority in your country.

Technical specifications

Intended delivered volume range (for ASV modes)

200-2500 mL

Maximum single fault steady state pressure

Device will shut down in the presence of a single fault if the steady state pressure exceeds:
40 cm H₂O (40 hPa) for more than 1 second.

Pressure measurement tolerance

± 0.5 cm H₂O (0.5 hPa) ±4% of measured reading

Flow measurement tolerance

± 6 L/min or 10% of reading, whichever is greater, at 0 to 150 L/min positive flow

Operating pressure range

CPAP 4-20 cm H₂O (4-20 hPa) (measured at the mask)

CPAP with EPR 4-20 cm H₂O (4-20 hPa) CPAP,
With EPR settings:
EPR off, Level 1 = 1.0 cm H₂O (1 hPa), Level 2 = 2.0 cm H₂O (2 hPa),
Level 3 = 3.0 cm H₂O (3 hPa)
EPR reduces the pressure during expiration by the amount dependent on the level set above, but the pressure delivered will not drop below 4.0 cm H₂O (4 hPa).

S IPAP: 4-25 cm H₂O (4-25 hPa), EPAP: 3-25 cm H₂O (3-25 hPa), Maximum pressure = 25 cm H₂O (25 hPa)
VAuto IPAP: 4-25 cm H₂O (4-25 hPa), EPAP: 4-25 cm H₂O (4-25 hPa), Pressure support: 0-10 cm H₂O (0-10 hPa),
Maximum pressure = 25 cm H₂O (25 hPa)

ASV and ASVAuto EPAP: 4-15 cm H₂O (4-15 hPa), Min PS: 0-6 cm H₂O (0-6 hPa), Max PS: 5-20 cm H₂O (5-20 hPa),
Maximum pressure = 25 cm H₂O (25 hPa)

Flow (maximum) at set pressures

The following are measured according to ISO 80601-2-70:2015 and ISO 80601-2-70:2020

With HumidAir 11 humidifier tub

Pressure cm H ₂ O (hPa)	AirCurve 11 and Standard air tubing L/min	AirCurve 11 and SlimLine L/min	AirCurve 11 and ClimateLineAir 11 L/min
4	161	170	161
8	165	174	169
12	167	177	175
16	169	172	170
20	167	165	165
25	164	156	156

With Side cover

Pressure cm H ₂ O (hPa)	AirCurve 11 and Standard air tubing L/min	AirCurve 11 and SlimLine L/min	AirCurve 11 and ClimateLineAir 11 L/min
4	208	194	193
8	200	189	188
12	192	182	181
16	184	176	176
20	176	170	167
25	166	159	158

Note: Refer to the relevant measurement uncertainty from the Measurement system uncertainties table.

Sound

Declared dual-number noise emission values in accordance with ISO 4871:1996

Device with standard air tubing and side cover as measured according to ISO 80601-2-70:2020 and ISO 80601-2-79:2018

Sound pressure level 26 dBA with uncertainty of 2 dBA

Sound power level 34 dBA with uncertainty of 2 dBA

Device with standard air tubing and HumidAir 11 humidifier tub (HumidAir 11 humidifier tub half-filled) as measured according to ISO 80601-2-70:2020, ISO 80601-2-74:2021 and ISO 80601-2-79:2018

Sound pressure level 27 dBA with uncertainty of 2 dBA

Sound power level 35 dBA with uncertainty of 2 dBA

Physical Dimensions

Dimensions (H x W x D) with HumidAir 11 humidifier tub: 3.72" x 10.21" x 5.45"
(94.5 mm x 259.4 mm x 138.5 mm)

Dimensions (H x W x D) with side cover: 3.72" x 9.32" x 5.45"
(94.5 mm x 236.8 mm x 138.5 mm)

Air outlet: The 22 mm conical outlet connector complies with EN ISO 5356-1:2015

Weight - device and HumidAir 11 humidifier tub: 43 oz (1229 g)

Weight - device with side cover: 44 oz (1236 g)

Housing construction: Flame retardant engineering thermoplastic

Hot plate - Material: Stainless steel

Water capacity: 380 mL

Time between each refill of the humidifier tub: > 8 hours ±0.5 hours (tested at 23 ±2°C / 73.4 ± 3.6 °F)

Humidifier tub - Material: Injection molded plastic, stainless steel and silicone seal

90W power supply unit

Input range 100-240 V, 50-60 Hz, 1.0-1.5 A
115 V, 400Hz, 1.5 A for aircraft use

DC output: 24 V  3.75 A

Typical power consumption: 65.3 W (72.5 VA)

Peak power consumption: 103.4 W (109.9 VA)

Class of equipment Class II

Environmental conditions

Operating temperature +41°F to +95°F (+5°C to +35°C)

Note: The airflow for breathing produced by this therapy device can be higher than the room temperature. Under extreme ambient temperature conditions (104°F/40°C) the device remains safe.

Operating humidity 10 to 95% relative humidity, non-condensing

Operating altitude Sea level to 9,870' (3,010 m); air pressure range 1060 hPa to 700 hPa

Storage pressure/Storage altitude 1060 to 700 hPa

Storage and transport temperature -13°F to +158°F (-25°C to +70°C)

Storage and transport humidity 5 to 95% relative humidity, non-condensing

Air Filter

Standard: Material: Polyester non woven fiber
Average arrestance: >75%, when tested to EN779.

Hypoallergenic: Material: Blended synthetic fibers in a polypropylene carrier
Efficiency: >80% (average) when tested to EN13274-7.

Note: The use of a ResMed approved hypoallergenic filter will result in a small reduction in the accuracy of the delivered pressure at high leaks.

Electromagnetic compatibility

The AirCurve 11 complies with all applicable electromagnetic compatibility requirements (EMC) according to IEC 60601-1-2:2020, for residential, commercial and light industry environments.

Portable and mobile RF communications equipment should be used no closer to any part of the machine, including cables, than the recommended 3.94" (10 cm) separation distance.

The AirCurve 11 has been designed to meet EMC standards. However, should you suspect that the device performance (eg. pressure or flow) is affected by other equipment, move the device away from the possible cause of interference.

Information regarding the electromagnetic emissions and immunity of this ResMed device can be found in [ResMed.com/downloads/devices](https://www.resmed.com/downloads/devices).

IEC 60601-1 (Edition 3.1) classification

Class II (double insulation), Type BF, Ingress protection IP22.

Supplemental oxygen maximum flow

15 L/min

Aircraft use

ResMed confirms that the machine meets the Federal Aviation Administration (FAA) requirements (RTCA/DO-160, section 21, category M; RTCA-DO-160, section 20, category T) for all phases of air travel.

Design life

Device, power supply unit:	5 years
Cleanable humidifier tub:	2.5 years
Standard humidifier tub, Air tubing:	6 months

General

The patient is an intended operator.

Pneumatic flow path

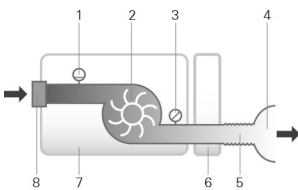

1. Flow sensor
2. Blower
3. Pressure sensor
4. Mask
5. Air tubing
6. Humidifier
7. Device
8. Inlet filter

Displayed values

Value	Range	Display resolution
Pressure at mask ¹ :		
Mask pressure	Minimum EPAP to maximum pressure (See section above Operating pressure range)	0.1 cm H ₂ O (0.1 hPa)
Flow derived values ¹ :		
Leak	0-120 L/min	0.1 L/min
Tidal volume	0-4000 mL	1 mL
Respiratory rate	0-90 BPM	1 BPM
Minute ventilation	0-30 L/min	0.1 L/min
Ti	0-10 sec	0.1 sec
I:E ratio	1:10-4:1	0.1

Value	Accuracy
Pressure at mask ¹ :	
Mask pressure	±0.5 cm H ₂ O (0.5 hPa) + 4% of set value
Flow and flow derived values ¹ :	
Flow	±6 L/min or 10% of reading, whichever is greater, at 0 to 150 L/min positive flow
Leak	±6 L/min, at 0 to 60 L/min ²
Tidal volume	±30 mL or 20% of reading, whichever is greater ²
Respiratory rate	±1.0 BPM ²
Minute ventilation	±20% ²

¹ Results are expressed as STPD (Standard Temperature and Pressure, Dry). Use the following table to convert the STPD flow setting to BTPS (Body Temperature and Pressure, Saturated) flow.

² Accuracy may be reduced by the presence of leaks, supplemental oxygen, tidal volumes <100 mL or minute ventilation <3 L/min.

STPD to BTPS conversion

Altitude (m)	Ambient pressure (hPa)	STPD to BTPS conversion factor
0	1013.25	1.12
500	956.53	1.19
1000	902.41	1.27
1500	850.80	1.36
2000	801.60	1.45
2500	754.73	1.54
3000	710.11	1.65

Pressure accuracy as tested according to ISO 80601-2-79:2018

± (0.5 cm H₂O (hPa) + 4% of the set pressure) cm H₂O (hPa)

Pressure accuracy - CPAP mode

Maximum static pressure variation at 10 cm H₂O (10 hPa) according to ISO 80601-2-70:2015 and ISO 80601-2-70:2020

Device with HumidAir 11 humidifier tub / side cover and air tubing: ±0.5 cm H₂O (±0.5 hPa)

Maximum dynamic pressure variation according to ISO 80601-2-70:2015

Device with HumidAir 11 humidifier tub / side cover and air tubing:

Breath rate	10 BPM	15 BPM	20 BPM
Dynamic pressure variation (cm H ₂ O [hPa])	0.5	0.5	0.8

Maximum dynamic pressure variation according to ISO 80601-2-70:2020

Device with HumidAir 11 humidifier tub / side cover and air tubing:

Maximum error from set pressure (cm H₂O [hPa]): ±1

Note: Refer to the relevant measurement uncertainty from the Measurement system uncertainties table.

Pressure accuracy - Bi-level modes

Maximum dynamic pressure variation according to ISO 80601-2-70:2015 and ISO 80601-2-70:2020

Device with HumidAir 11 humidifier tub / side cover and air tubing:

Inspiration/Expiration mean error ± standard deviation (cm H₂O [hPa]): 1±0.1

Note: Refer to the relevant measurement uncertainty from the Measurement system uncertainties table.

% of Inspiratory Phase for calculation: > 60

% of Expiratory Phase for calculation: > 66

Note: For each inspiratory and expiratory breath phase, the data time slot starts immediately after the initial transient overshoot/undershoot period and ends at the point when flow diminishes to an absolute value equivalent to its starting point, towards the end of the breath phase.

Measurement system uncertainties

In accordance with ISO 80601-2-70:2020 and ISO 80601-2-79:2018 the measurement uncertainty of the manufacturer's test equipment is:

For measures of flow:	± 3.9 L/min
For measures of volume:	± 6 mL or 5% (whichever is greater)
For measures of static/dynamic pressure:	± 0.15 cm H ₂ O (± 0.15 hPa)
For measures of time:	± 6 ms

In accordance with ISO 80601-2-74:2021 the measurement uncertainty of the manufacturer's test equipment is

For measures of humidification output:	± 0.5 mg/L BTPS
--	-----------------

Bluetooth

Technology used:	Bluetooth Low Energy (BLE)
Connection types:	GATT
Frequency:	2400 to 2483.5 MHz
Max RF power output:	+4 dBm
Operation range:	10 m (Class 2)

Cellular technology and regulatory compliance

Refer to the Cellular information guide in [ResMed.com/downloads/devices](https://www.resmed.com/downloads/devices).

The device should be installed and operated with minimum distance 15 mm (0.59") between the equipment and the user's body.

Humidifier

Maximum heater plate temperature:	154°F (68°C)
Temperature cut-out (heater):	165°F (74°C)
Maximum gas temperature (at mask) ¹ :	≤ 106°F (41°C)

¹ The air flow for breathing produced by this therapy device can be higher than the temperature of the room. Under extreme ambient temperature conditions (104°F/40°C) the device remains safe.

Humidifier performance

SlimLine/Standard tubing

Mask Pressure cm H ₂ O (hPa)	Nominal RH output % at 72°F (22°C) ambient temperature		Nominal system output mg/L AH ¹ , BTPS ²	
	Setting 4 (default setting)	Setting 8 (maximum setting)	Setting 4 (default setting)	Setting 8 ³ (maximum setting)
3	80%	100%	≥6	≥12
4	80%	100%	≥6	≥12
10	80%	100%	≥6	≥12
20	80%	100%	≥6	≥12
25	80%	100%	≥6	≥12

Climate Control Auto - ClimateLineAir 11

Mask Pressure cm H ₂ O (hPa)	Nominal RH output % at 72°F (22°C) ambient temperature	Nominal system output mg/L AH ¹ , BTPS ²
3	85%	≥ 12
4	85%	≥ 12
10	85%	≥ 12
20	85%	≥ 12
25	85%	≥ 12

¹ AH - Absolute Humidity in mg/L

² BTPS - Body Temperature Pressure Saturated

³ Humidifier performance meets ISO 80601-2-74:2021 performance > 10 mg/L BTPS tested at 59°F to 95°F (15°C to 35°C)

Air tubing





















	ClimateLineAir 11	SlimLine / Standard 2m / Standard 3m
ClimateLineAir 11 temperature range	60 to 86°F (16 to 30°C)	-
ClimateLineAir 11 temperature cut out	≤106°F (≤41°C)	-
Maximum recommended pressure	30 cm H ₂ O (30 hPa)	30 cm H ₂ O (30 hPa)
Maximum working temperature, when used with a humidifier	-	≤106°F (≤41°C)
Material	Flexible plastic and electrical components	Flexible plastic
Inner diameter	0.6" (15 mm)	SlimLine: 0.6" (15 mm) Standard 2m: 0.74" (19 mm) Standard 3m: 0.74" (19 mm)
Length	6'6" (2.0 m)	SlimLine: 6' (1.8 m) Standard 2m: 6'6" (2.0 m) Standard 3m: 9'10" (3.0m)

Note: The manufacturer reserves the right to change these specifications without notice.

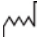
Air tubing resistance to flow and compliance information

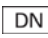
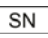
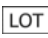
Refer to the Air tubing compliance guide in ResMed.com.

Symbols

 Follow instructions before use.  Indicates a warning or caution.  Temperature limitation.
 Humidity limitation.  Operating altitude.  Atmospheric pressure limitation.  Manufacturer.
 Direct current.  Class II equipment.  IP22 Protected against finger sized objects and against dripping water when tilted up to 15 degrees from specified orientation.  Non-ionizing radiation.  MR unsafe (do not use in the vicinity of an MRI device).  RTCA/DO-160 Section 21, Category M Compliant & FAA Compliant.  Type BF applied part.  Date of Manufacture  Medical device.
 Catalog number.  Device number.  Serial number.  Batch code.
 European Authorized Representative.  Bluetooth  Start therapy/Standby.

Rx Only Prescription only (In the US, Federal law restricts these devices to sale by or on the order of a physician). **Distilled Water Only** Use distilled water only. **MAX** Maximum water level.  Open tub to fill.

See symbols glossary at ResMed.com/symbols.

 Environmental information

This device should be disposed of separately, not as unsorted municipal waste. To dispose of your device, you should use appropriate collection, reuse and recycling systems available in your region. The use of these collection, reuse and recycling systems is designed to reduce pressure on natural resources and prevent hazardous substances from damaging the environment.

If you need information on these disposal systems, please contact your local waste administration. The crossed-bin symbol invites you to use these disposal systems. If you require information on collection and disposal of your ResMed device please contact your ResMed office, local distributor or go to ResMed.com/environment.

California Perchlorate Information:

The coin-cell battery within this device may contain Perchlorate Material - special handling may apply.
See: www.dtsc.ca.gov/hazardouswaste/perchlorate

Hazardous Materials information

Refer to the booklet packed with the device or refer to the Hazardous materials guide in ResMed.com.

Servicing

The AirCurve 11 device is intended to provide safe and reliable operation when operated in accordance with the instructions provided by ResMed. ResMed recommends that the AirCurve 11 device be inspected and serviced by an authorized ResMed Service Center if there is any sign of wear or concern with device function. Otherwise, service and inspection of the products generally should not be required during their design life.

Limited warranty

ResMed Pty Ltd (hereafter 'ResMed') warrants that your ResMed product shall be free from defects in material and workmanship from the date of purchase for the period specified below.

Product	Warranty period
<ul style="list-style-type: none">• Mask systems (including mask frame, cushion, headgear and tubing)—excluding single-use devices• Accessories—excluding single-use devices• Flex-type finger pulse sensors• Humidifier standard water tubs	90 days
<ul style="list-style-type: none">• Batteries for use in ResMed internal and external battery systems	6 months
<ul style="list-style-type: none">• Clip-type finger pulse sensors• CPAP and bilevel device data modules• Oximeters and CPAP and bilevel device oximeter adapters• Humidifiers and humidifier cleanable water tubs• Titration control devices	1 year
<ul style="list-style-type: none">• CPAP, bilevel and ventilation devices (including external power supply units)• Battery accessories• Portable diagnostic/screening devices	2 years

This warranty is only available to the initial consumer. It is not transferable.

During the warranty period, if the product fails under conditions of normal use, ResMed will repair or replace, at its option, the defective product or any of its components.

This limited warranty does not cover: a) any damage caused as a result of improper use, abuse, modification or alteration of the product; b) repairs carried out by any service organization that has not been expressly authorized by ResMed to perform such repairs; c) any damage or contamination due to cigarette, pipe, cigar or other smoke; and d) any damage caused by exposure to ozone, activated oxygen or other gasses.

Warranty is void on product sold, or resold, outside the region of original purchase.

Warranty claims on defective product must be made by the initial consumer at the point of purchase.

This warranty replaces all other expressed or implied warranties, including any implied warranty of merchantability or fitness for a particular purpose. Some regions or states do not allow limitations on how long an implied warranty lasts, so the above limitation may not apply to you.

ResMed shall not be responsible for any incidental or consequential damages claimed to have resulted from the sale, installation or use of any ResMed product. Some regions or states do not allow the exclusion or limitation of incidental or consequential damages, so the above limitation may not apply to you.

This warranty gives you specific legal rights, and you may also have other rights which vary from region to region. For further information on your warranty rights, contact your local ResMed dealer or ResMed office.

For limited warranty information for the United States, visit ResMed.com or call 1-800-424-0737.

Further information

If you require additional information on how to setup, use or maintain the Air11™ system (including ClimateLineAir 11 heated tubing), or to report unexpected operation or events, please contact the ResMed Service Center or your care provider.