

## Ultra Mirage™ Full Face Mask

The ultimate solution for mouth leak

### Fitting Guide



#### Selecting the correct mask size

- Select smallest fitting template that fits most closely around outside corners of mouth.
- Template should rest in groove between lower lip and chin. Top of template should rest under eyebrow level. This indicates correct mask frame size.
- If line of nose is below dotted template line, use Shallow cushion profile. If above, use Standard cushion profile.

#### Fitting the mask

- Move forehead support tab to uppermost position (position 4).
- Disconnect lower headgear clip.



- 1
- Place mask on face and pull headgear over head.
  - Make sure upper straps pass across forehead and lower straps below ears.
  - Reattach headgear clip to mask frame.



- 3
- Connect one end of air tubing to mask swivel and other end to flow generator.
  - Turn flow generator on.
  - If air leaks around cushion you may need to change the position of the forehead support tab.



- 2
- Gently tighten upper and lower headgear straps. The forehead support pads should lightly touch the forehead. Do not overtighten straps.



- 4
- Loosen upper headgear straps and move forehead support tab downward to next position (position 3).
  - Gently tighten upper headgear straps.
  - Test all four positions of forehead support tab and adjust headgear straps until you achieve a secure and comfortable fit.

## Ultra Mirage™ Full Face Mask

The ultimate solution for mouth leak

Mouth breathing and leak are common problems for CPAP and bilevel therapy users. These problems result in ineffective therapy, discomfort and disrupted sleep—all of which can cause patients to be noncompliant or to abandon therapy altogether.

ResMed's Ultra Mirage™ Full Face Mask covers both the nose and mouth so patients receive effective therapy even in the presence of mouth breathing and leak.

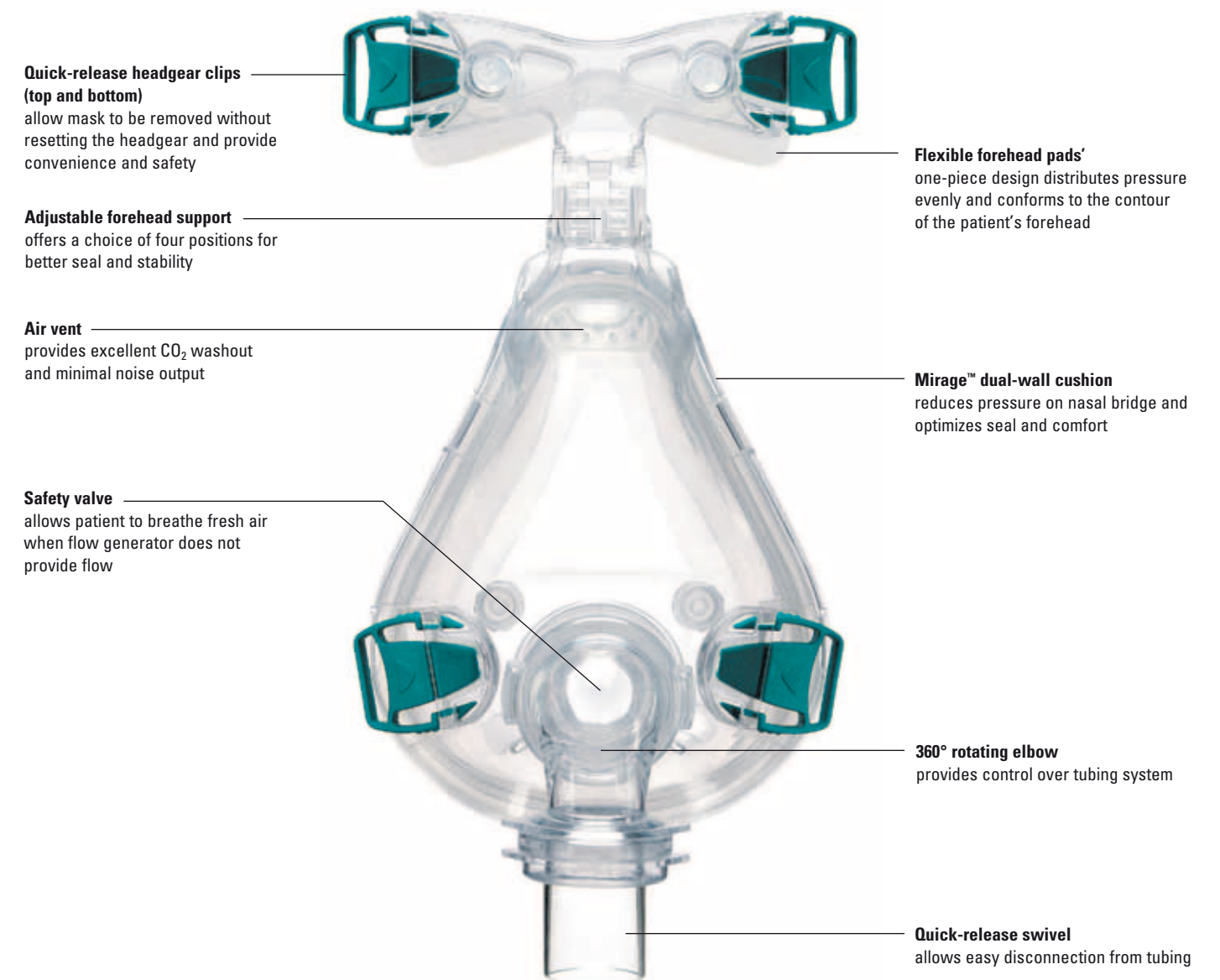

### TECHNOLOGY HIGHLIGHT—ADJUSTABLE FOREHEAD SUPPORT AND PADS

The adjustable forehead support takes seal performance to a new level.

- Enhanced stability is achieved by minimizing movement of the mask relative to the face. Seal is maintained even when the patient moves during sleep.
- Four adjustable positions optimize seal and comfort.
- The flexible forehead pads conform to the contour of the patient's forehead.
- The pads distribute pressure evenly over a larger surface area, reducing pressure on the patient's face.



### PATIENT BENEFITS

#### Trusted comfort with proven technology

- Mirage cushion technology reduces pressure on the nose and optimizes seal and comfort.

#### Superior seal through enhanced stability

- Adjustable forehead support and pads help maintain seal even with patient movement.

#### User convenience

- Quick-release headgear clips enable quick and easy mask fitting and removal. Once set up, the headgear doesn't have to be readjusted.

### PROFESSIONAL BENEFITS

#### Confidence in effective therapy delivery

- As the mask covers both the nose and mouth, it provides effective therapy in the presence of mouth breathing.
- Minimizes the effects of mouth breathing to help optimize patient compliance.

#### Peace of mind

- Minimal dead space, superior airflow characteristics and the built-in air vent minimize CO<sub>2</sub> rebreathing.
- Quick-release headgear clips allow for easy removal.
- Built-in safety valve allows patient to breathe fresh air when the flow generator provides no airflow.

#### Efficient mask size selection

- 3-D fitting templates help achieve first-time fit.
- Templates may also help reduce mask fitting time and minimize callbacks and returns.

### ULTRA MIRAGE FULL FACE MASK SYSTEM PRODUCT CODES

#### North & Latin America

Small Standard	60600
Small Shallow	60601
Medium Standard	60602
Medium Shallow	60603
Large Standard	60204
Large Shallow	60605

# Ultra Mirage™ Full Face Mask

## Components Card

### Ultra Mirage Full Face mask system (complete system with headgear and cushion)

SSt	60600
SSh	60601
MSt	60602
MSh	60603
LSt	60604
LSh	60605

### Frame system with cushion<sup>1</sup> (no headgear)

SSt	60620
SSh	60621
MSt	60622
MSh	60623
LSt	60624
LSh	60625

### Headgear (no clips)

S	16118
St	60674
L	16119

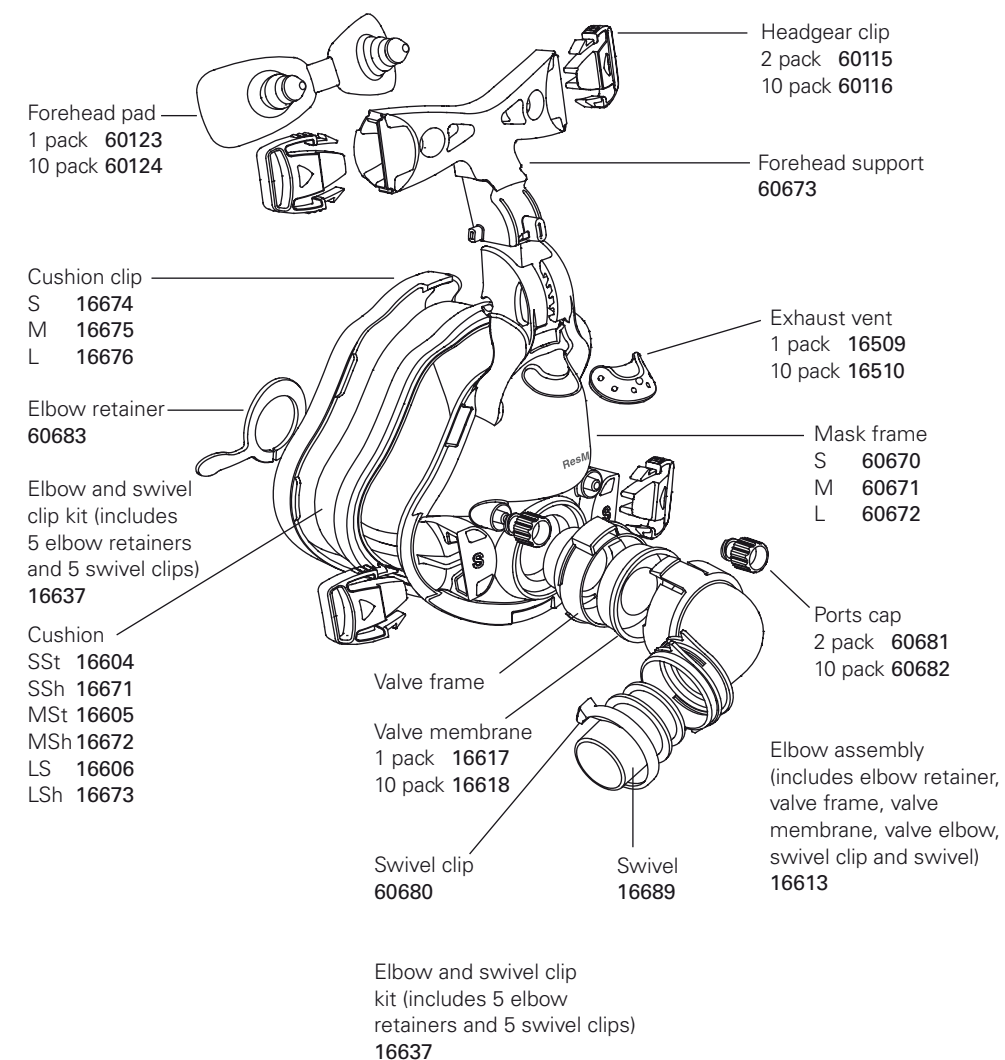

S	Small	St	Standard
M	Medium	L	Large
SSt	Small Standard	SSh	Small Shallow
MSt	Medium Standard	MSh	Medium Shallow
LSt	Large Standard	LSh	Large Shallow

<sup>1</sup> Includes headgear clips